

| | | | |
|---|-----------------|---|---|
|  | Form Title: | ENGINEERING BULLETIN | Document #: EB-03-24 <small>(Form: DEF-003A-1)</small> |
| | Document Title: | Obsolete B20 Lamp Replacement with Button Lamp | Revision: 0 |
| | | | Date: March 21, 2024 |
| | | | Page: 1 of 1 |

Description of Bulletin: The B20 marker and turn lamp assemblies are now obsolete and have been replaced with the 3/4" button lamp. This bulletin provides details of the replacement choices and describes details of the available and recommended options.

Obsolete B20 Lamp Assembly – The B20 was surface mounted and required the mounting configuration as shown.

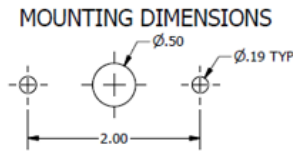

Button Lamp with B20 Style Adaptor Plate – This adaptor plate is available for applications where the mounting configuration cannot be changed over to the to the standard Button Lamp grommet mount. The adaptor plate mounts to the same bolt pattern as the B20. The Button Lamp comes with 6" Shur-Plug 180 male bullet connections.

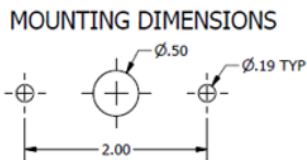
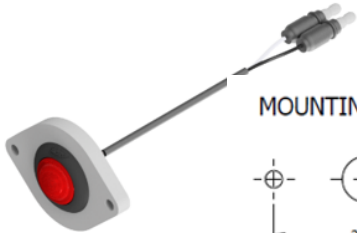

| PART # | DESCRIPTION |
|----------|---------------------------------|
| 75846EP | GROMMET – BUTTON LAMP - .25 THK |
| MR75GS2M | RED BUTTON LAMP ASSEMBLY |
| MA75GS2M | AMBER BUTTON LAMP ASSEMBLY |
| 76286AL | B20 PLATE ADAPTER |

Button Lamp Grommet Mount – The standard Button Lamp is the cost-effective solution recommended for new construction and recommended for replacement when the mounting holes can be adjusted to accommodate the grommet. The Button Lamp comes with 6" Shur-Plug 180 male bullet connections and grommet mounting is restricted to a .25" maximum plate thickness.

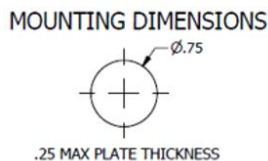

| PART # | DESCRIPTION |
|------------|---------------------------------|
| 75846EP | GROMMET – BUTTON LAMP - .25 THK |
| 75846EP001 | GROMMET – BUTTON LAMP - .12 THK |
| MR75GS2M | RED BUTTON LAMP ASSEMBLY |
| MA75GS2M | AMBER BUTTON LAMP ASSEMBLY |

See online catalog at www.bettsind.com for additional details. If there are any questions, contact Betts Customer Service or Betts Design Engineering at (814) 723-1250.