	Form Title:	<b>ENGINEERING BULLETIN</b>	Document #: <b>EB-02-24</b> <small>(Form: DEF-003A-1)</small>
	Document Title:	<b>Rear Head Valve Product Improvement and New Part Numbering Code Rollout</b>	Revision: <b>0</b>
			Date: <b>Mar. 20, 2024</b>
			Page: <b>1 of 1</b>

**Details of Design Change and Minor Dimensional Change:**

A product improvement has been implemented on Rear Head Valves to eliminate a weld joint in the body and also improve the squareness of the valve seat with respect to the tophead sealing surface. With this change, there is a minor adjustment to the dimensions of the body.

Valves produced PRIOR TO Spring of 2024.

Valves produced AFTER Spring of 2024

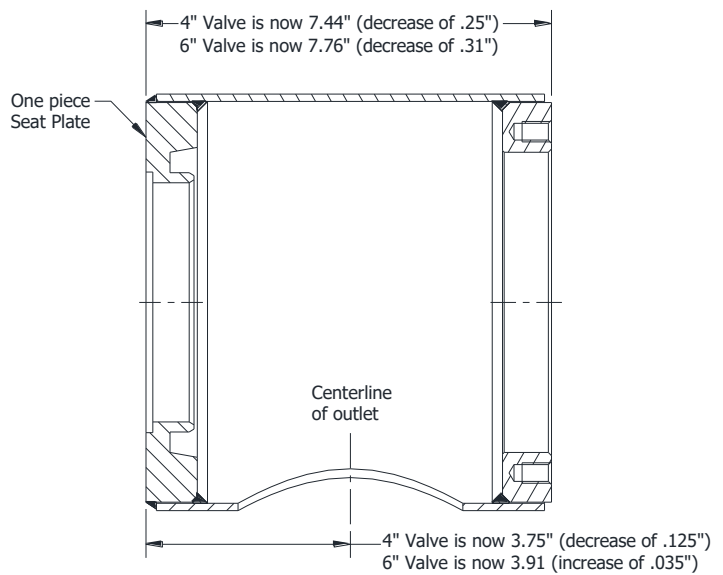
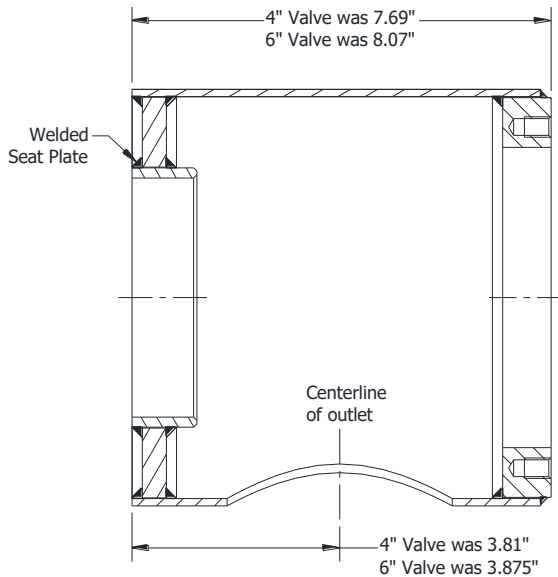

**New Part Number Code Rollout:**

The old part numbers for the Rear Head Valves were numbers associated with the engineering drawing number of the valve. The new part numbering code is a representative part numbering system where each letter or digit in the part number is indicative of a feature of the valve. A three digit suffix is used to designate specials.

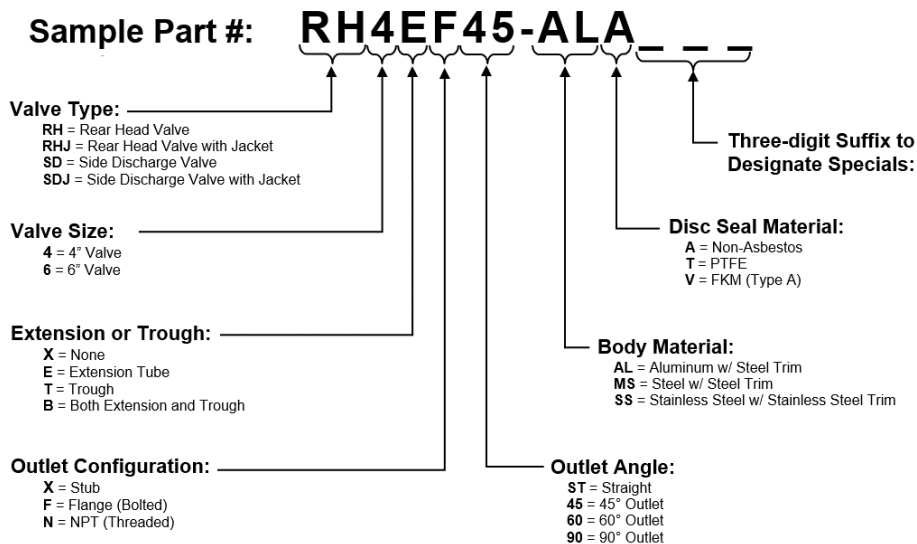

Please review the Betts website at [www.bettsind.com](http://www.bettsind.com) for more detailed dimensional information as well as a cross reference chart for old Rear Head Valve part numbers to new Rear Head Valve part numbers.