

Betts Industries, Inc.

1800 Pennsylvania Ave. West
Warren, PA 16365 U.S.A.

Engineering Bulletin 3-98

Date: 4/3/98

Subject: Betts Wet-R-Dri Valve Air Actuator – Manual operation in case of air system failure.

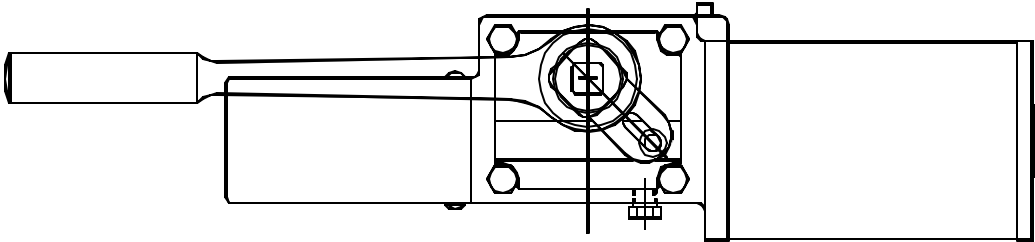

2", 3", 4" & 5" VALVE ASSEMBLIES USE $\frac{1}{2}$ " DRIVE SOCKET WRENCH & EXTENSION

6", 8" & 12" VALVE ASSEMBLIES USE $\frac{3}{4}$ " DRIVE SOCKET WRENCH & EXTENSION

