



4" Manually Operated TTMA Detent Wet-R-Dri Butterfly Valve



The Betts Wet-R-Dri Valve is a lightweight and compact quarter turn in-line stop valve. This easily maintained and versatile valve is widely used for liquid, gaseous or dry products and is available in a variety of sizes. The manual detent model provides a positive stop in the open and closed position as well as a detent spring and ball which assist in holding the disc in the open or closed position. The body is offered in aluminum, cast iron or stainless-lined with coatings available for increased chemical resistance and extended service life. The disc seal and shaft O-rings are available in a variety of materials to optimize chemical resistance and service temperature range. Bolt pattern matches TTMA piping flange dimensions.

Assembly Number	Body Material	Dimensions	Maximum Working Pressure	Weight
WD401AL*	Aluminum	A: 6 3/4" (171.5 mm) B: 5 1/8" (130.2 mm) C: 1 1/8" (280.6 mm) O.D.: 6 5/8" (168.6 mm) I.D.: 4 3/8" (111.1 mm) B.C.: 5 7/8" (149.2 mm) Holes 8-7/8" (8-11 mm)	75 psi (5.17 bar)	4.5 lbs. (2.04 kg)
WD401GI*	Cast Iron	A: 6 3/4" (171.5 mm) B: 5 1/8" (130.2 mm) C: 1 1/8" (280.6 mm) O.D.: 6 5/8" (168.6 mm) I.D.: 4 3/8" (111.1 mm) B.C.: 5 7/8" (149.2 mm) Holes 8-7/8" (8-11 mm)	75 psi (5.17 bar)	8.3 lbs. (3.75 kg)

* Replace asterisk in part number to designate disc coating.

WD401ALWB

(4" Wet-R-Dri Aluminum + White FDA Nitrile)

Seal Materials	Temperature Range
B = Black Nitrile (Buna-N)	-40°F to +240°F (-40°C to +116°C)
WB = White FDA Nitrile (Buna-N)	-40°F to +240°F (-40°C to +116°C)
OP = White FDA Nitrile with SS Insert	-40°F to +240°F (-40°C to +116°C)
VB = FKM (Viton™ B) Type B	+9°F to +400°F (-13°C to +204°C)
VF = FKM GFLT-S	-11°F to +400°F (-24°C to +204°C)
V = FKM (Viton™ A) Type A	-0°F to +400°F (-17°C to +204°C)
U = Black Urethane	-40°F to +200°F (-40°C to +93°C)
E = Black EPDM	-50°F to +250°F (-45°C to +121°C)
WE = White EPDM	-50°F to +250°F (-45°C to +121°C)

Not all materials are available for every size. Actual temperature values may vary due to service conditions.

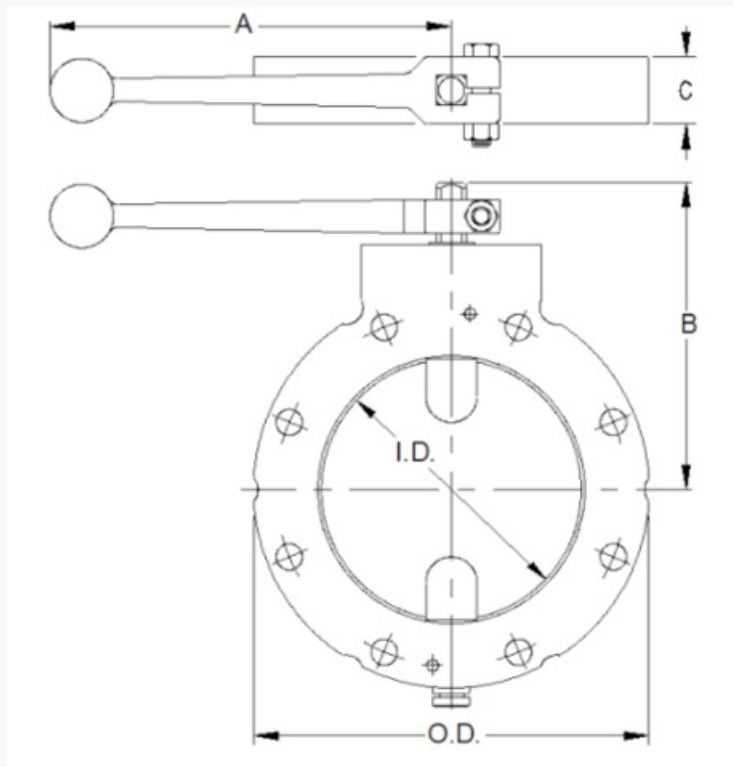



Repair Kits Wet-R-Dri Valve

Betts prides itself in being able to provide products that meet a customer's specific needs. As a result we do offer modifications to our product standards. While not every request is always feasible, we do our best to meet your specific needs. In many cases this modification is noted by adding a suffix to the end of the standard part number. The following is a non-inclusive list of common options that are available for this product line . If the options listed below do not meet your requirements please contact one of Betts' Customer Service Representatives for further assistance. Please note that some product modifications may result in extended lead times.

Commonly Used Suffixes (Add to End of Assembly Number)

- 001** = E-Coated Valve Body
- 002** = Greased Fittings in Shafts
- 004** = Valve Less Handle
- 019** = SS Shafts with SS Liner
- 032** = Left Handed Operation
- 046** = E-Coated Valve Left Hand operation
- 089** = 225 psi Tested with Fluorosilicone O-Rings

Example Assembly

WD401ALWB002

(4" Wet-R-Dri Aluminum + White FDA Nitrile + Greased Fittings in Shafts)

The Wet-R-Dri Valve may be mounted in any position with handle located for easy operation. Standard right-hand operation opens by turning handle quarter turn counterclockwise and left-hand operation (clockwise opening) is available for valve with suffix "032". Care should be taken when mounting valve to be sure the I.D. of adjoining flanges or pipe is large enough to allow the disc of the valve to open freely. It is recommended to use Betts flanges and adapters shown in Section 20, Page 5A.

EB-02-17: Wet-R-Dri Valve Product Family Changes and New Product Introduction

SB9-08: Wet-R-Dri Valve Viton® Disc Material Update

EB6-99: Installation Procedure for 3" and 4" Wet-R-Dri Valves with 1-1/8" Thick Bodies

 **WARNING:** This product can expose you to chemicals including Chromium (hexavalent compounds) which is known to the State of California to cause cancer, birth defects or other reproductive harm. For more information go to: www.P65Warnings.ca.gov. For additional information on Betts products and Proposition 65 list please see: <http://www.bettsind.com/prop-65/>