

Betts Industries, Inc.

1800 Pennsylvania Ave. West
Warren, PA 16365 U.S.A.

Engineering Bulletin 4-97-B

Subject: O-ring Replacement Instructions for Betts Ecliptic Valve Shafts

Date: May 1997

Note: Lubricate tool (part no. 27674MS) with petroleum jelly or silicone grease before attempting to slide O-rings onto tool.



1. Heat O-rings (part no. 18582TS) in boiling water for 2 to 3 minutes.

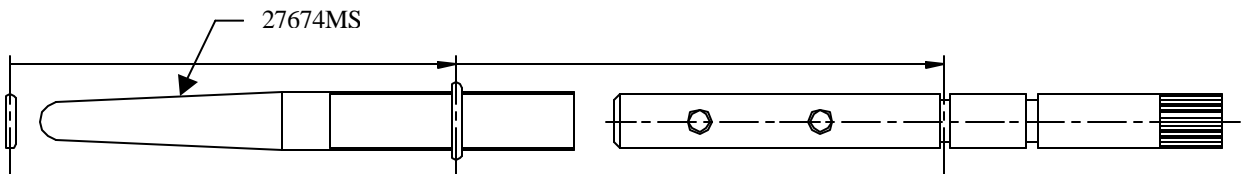

2. While still warm, slide first o-ring onto tool 27674MS. Insert smooth end of shaft into cavity in end of tool and slide o-ring off tool and into first groove.

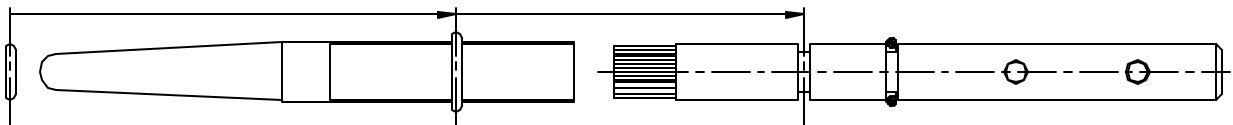

3. Insert splined end of shaft into tool cavity and repeat step 2 with second o-ring.

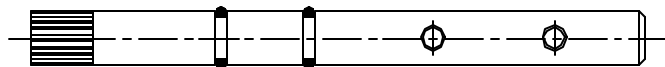

4. Remove shaft from tool after installing second o-ring. O-rings will be loose on shaft due to stretching during installation. Heat shaft and o-rings in boiling water for 2 to 3 minutes or until o-rings tighten on shaft.